

SPAN

Span mounting system uses a series of pre-installed clips and rails that are mounted to the back of the panel. The panels are then suspended via t-bar grid from the ceiling. Typically the span system is used for areas where a singular row of panels are required i.e. hallways or corridors.

GUIDELINES:

- T-Clip with T-bar (by others) are required for panels over 5'-0" (1525mm).
- Any items located in the ceiling or wall must be independently supported (ie. Lights, diffusers, sprinklers). The panel are not structurally capable of supporting any weight.
- Speaker grilles are recommended to be visibly mounted at the face of the panel. Speaker function creates air movement and premature soiling will develop onto the panel.

FEATURES:

- A single panel which spans across a hallway, corridor, etc.
- Span area up to 10'-0" (3050mm).
- Panel supported by opposite end molding or support angle.
- Plenum is accessible

MAINTENANCE

Contact Sky Acoustics for SPAN maintenance instructions.

SPAN MOUNTING SYSTEM (T-BAR SUPPORT)

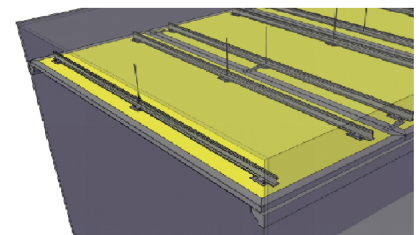

T-BAR INSTALLATION

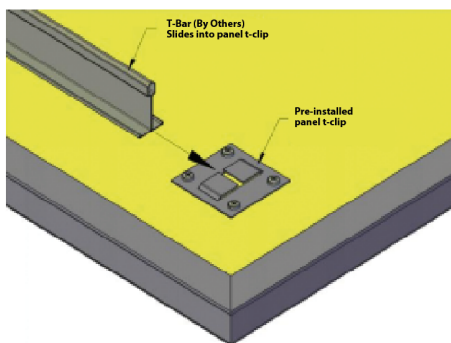

LAY-IN AT CROWN MOLDING

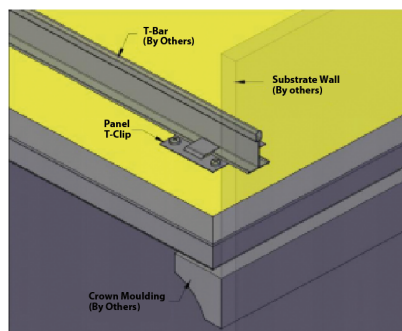

PANEL CLIP ALIGNMENT

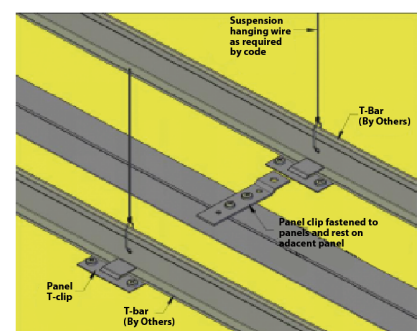

www.sky-acoustics.com

55 Bradwick Dr, Concord, ON L4K 1K5

Phone: (647) 477-2200

Email: sales@sky-acoustics.com