



AURA

AURA

CEILINGS & WALLS

ALUMINUM EDGE ACOUSTICAL PANEL

AURA is the most accurate panel on the market. It's unique metal edge design controls panel thickness, size and shape and is unmatched in appearance specifically when butt joining panels is required

Project: SEIR Building
Location: Texas
Architect: Page / ZGF Architects
Finish: COATED - AURA White



Project: Omni Hotel
Location: Boston , USA
Architect: Elkus Manfredi Architects
Finish: LOHA- "Dye sublimation Walnut"(Perforated metal) [Fabric wrapped baffles]

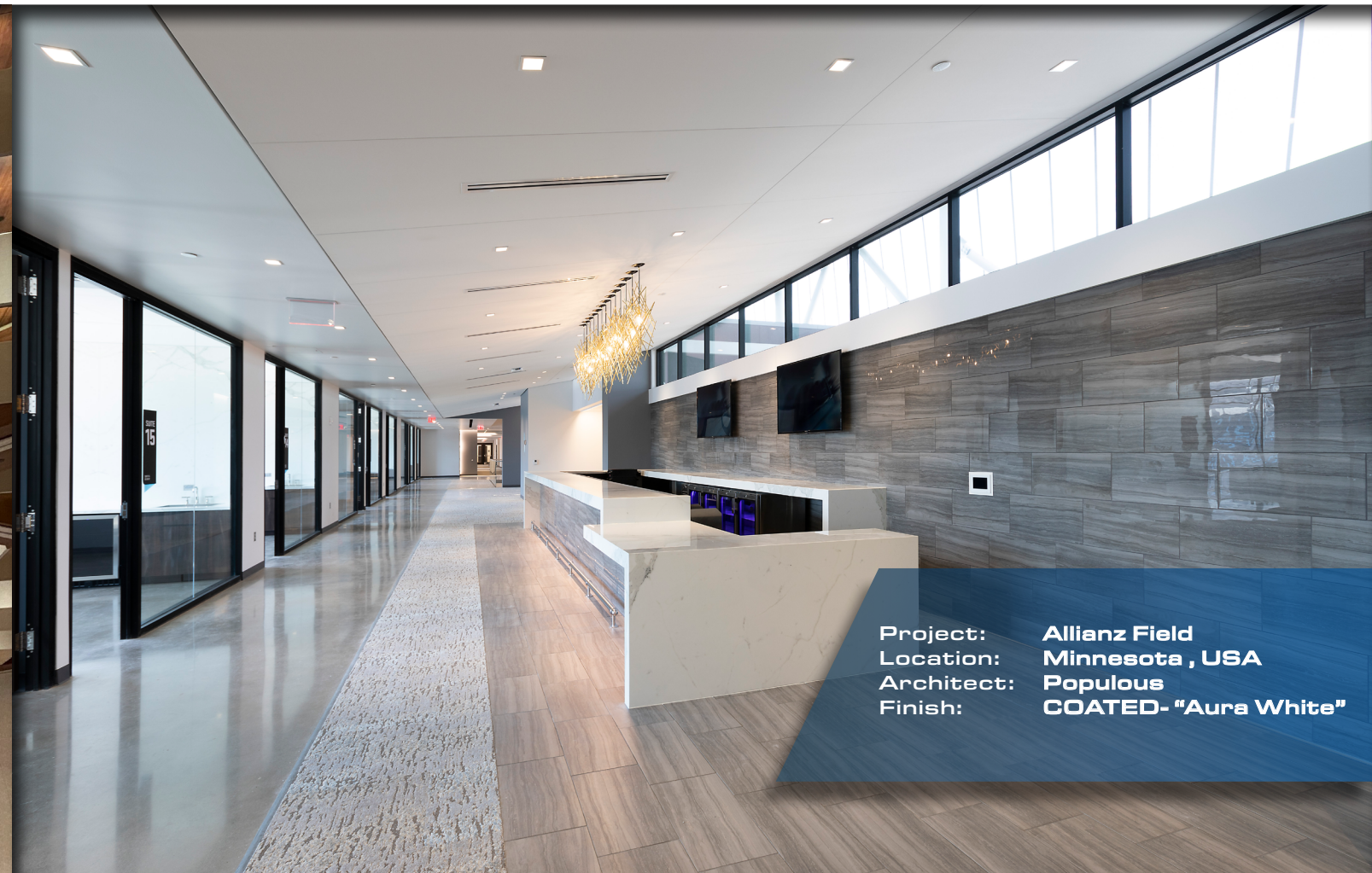

Project: Allianz Field
Location: Minnesota , USA
Architect: Populous
Finish: COATED- "Aura White"



Project: IPSOFT
Location: New York City, USA
Architect: Skidmore,Owings & Merrill
Finish: COATED- "Aura White"



Project: Saint Francis College
Location: New York City, USA
Architect: Switzer
Finish: LEGNO - "Recon Rift White Oak"(Micro perforated wood Veneer)



FEATURES & BENEFITS

- Fiberglass core : Reduces noise
- Aluminum extruded edge : Best for butt joining and precise size control
- Compatible with APTUS grid : 100% downward accessible concealed grid system for a clean contemporary look. [See SUSPENSION SYSTEMS for more details].
- Customizable : Its your design, the finishes and color palettes are endless [See FINISHES for more details].
- Integrations: Helps keep the ceiling organized and adds more design options to meet your needs. [See ACCESSORIES for more details]

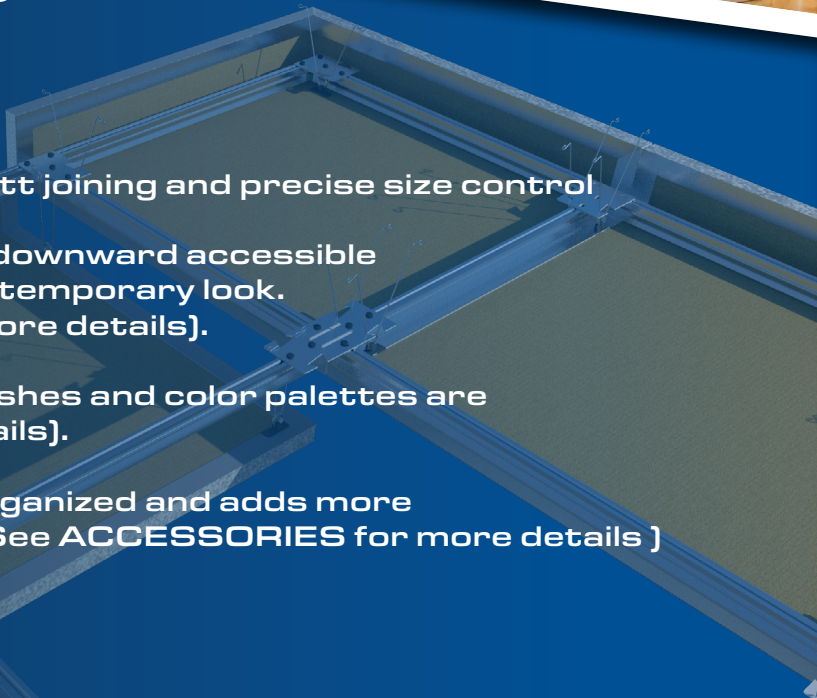

Project: TQL Stadium
 Location: Cincinnati, USA
 Architect: Populous
 Finish: COATED- "Aura Black"

APTUS GRID SYSTEM + UTILITY TRACK

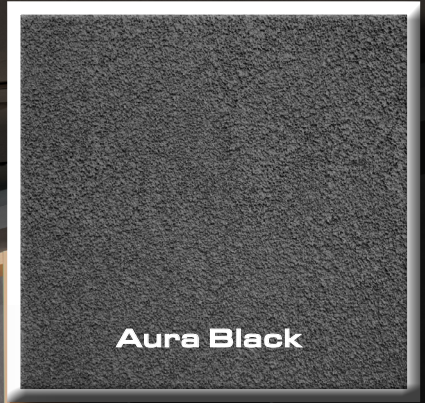

Aura Black



Design Accessories

Utility Track

The integration of utility tracks into a Sky Acoustic AURA ceiling is the ultimate way to organize your busy ceilings. These tracks eliminate field cutting, and ensure your entire ceiling is accessible. These tracks have been designed to integrate quickly into our APTUS grid and can be customized for your design needs; from color to size and curves you are in the drivers seat.

Recessed Track

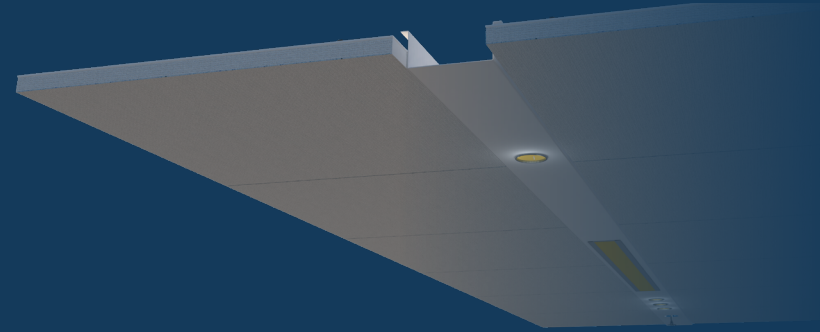

Flush Track

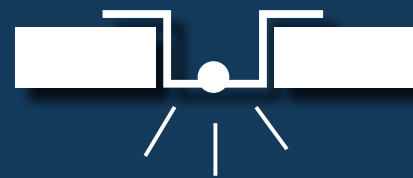

Knife Edge

Available in an array of sizes and finishes.

Knife Edges add a subtle yet impactful element of elegance, seamlessly blending with the overall design while enhancing the visual appeal.

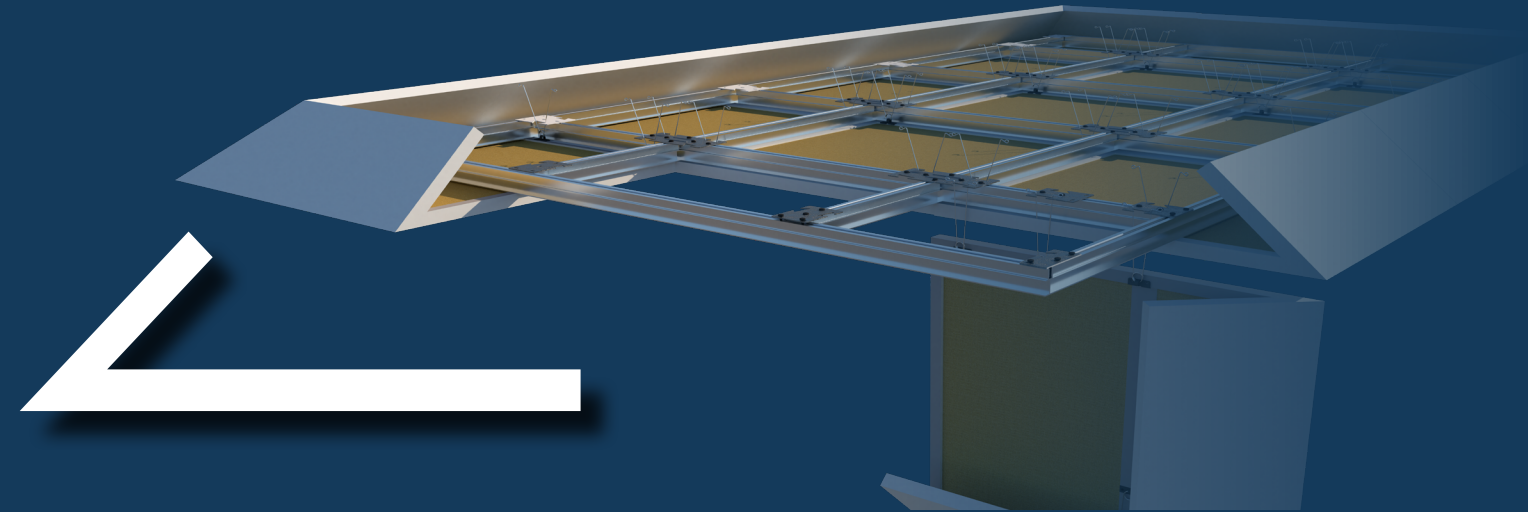

Metal Return

Metal edge returns are a field applied return that adds depth to the system or can be used to terminate an otherwise exposed ceiling detail.

These metal trims are versatile, allowing them to seamlessly integrate with various panel designs. Whether the goal is to conceal lighting fixtures, create a sleek border, or achieve a floating island appearance, metal edge returns can fulfill these design needs effectively.

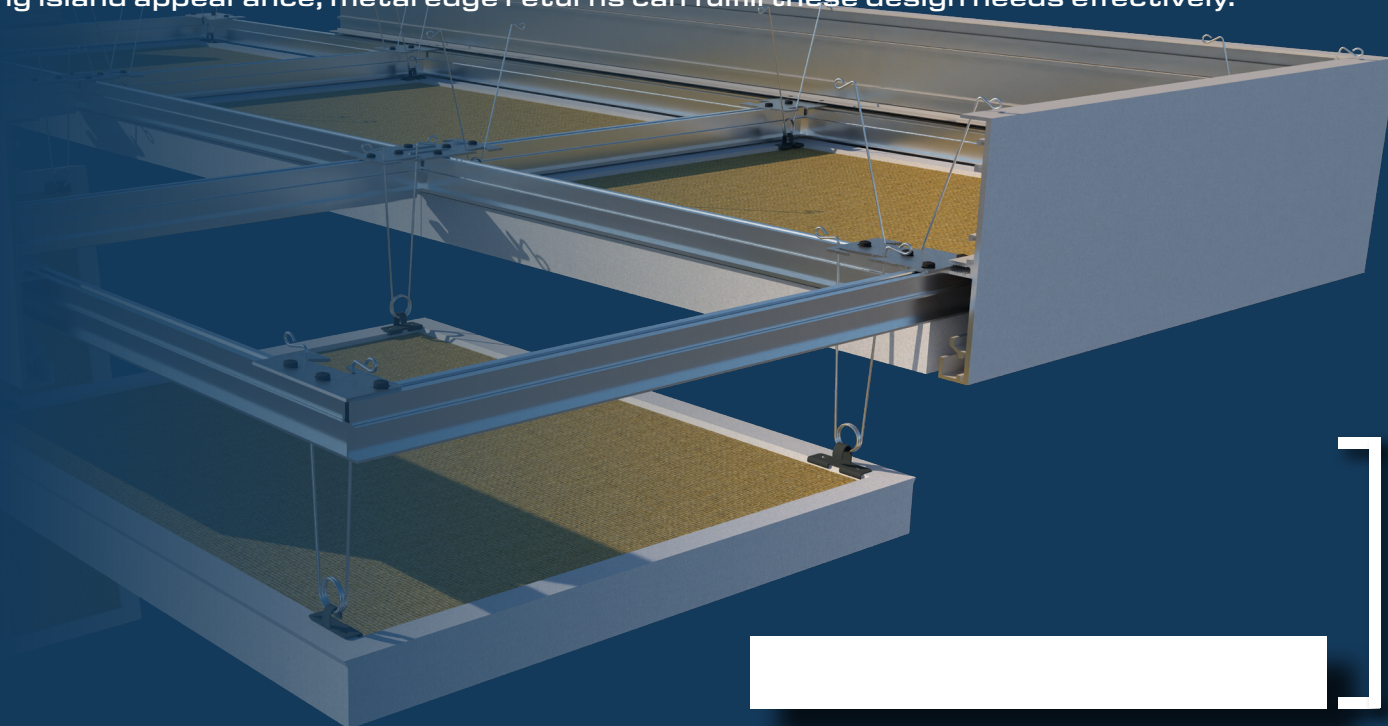

Design Returns

Similar to our metal edge returns, our design returns are a seamless factory built option.

These design returns can be included to achieve a concealed ceiling look while preserving the aesthetic appeal of the panel design. They are adeptly crafted to blend with the ceiling, creating a unified and elegant appearance. This approach enhances the visual continuity of the space, allowing the ceiling to return as an integral part of the overall design.

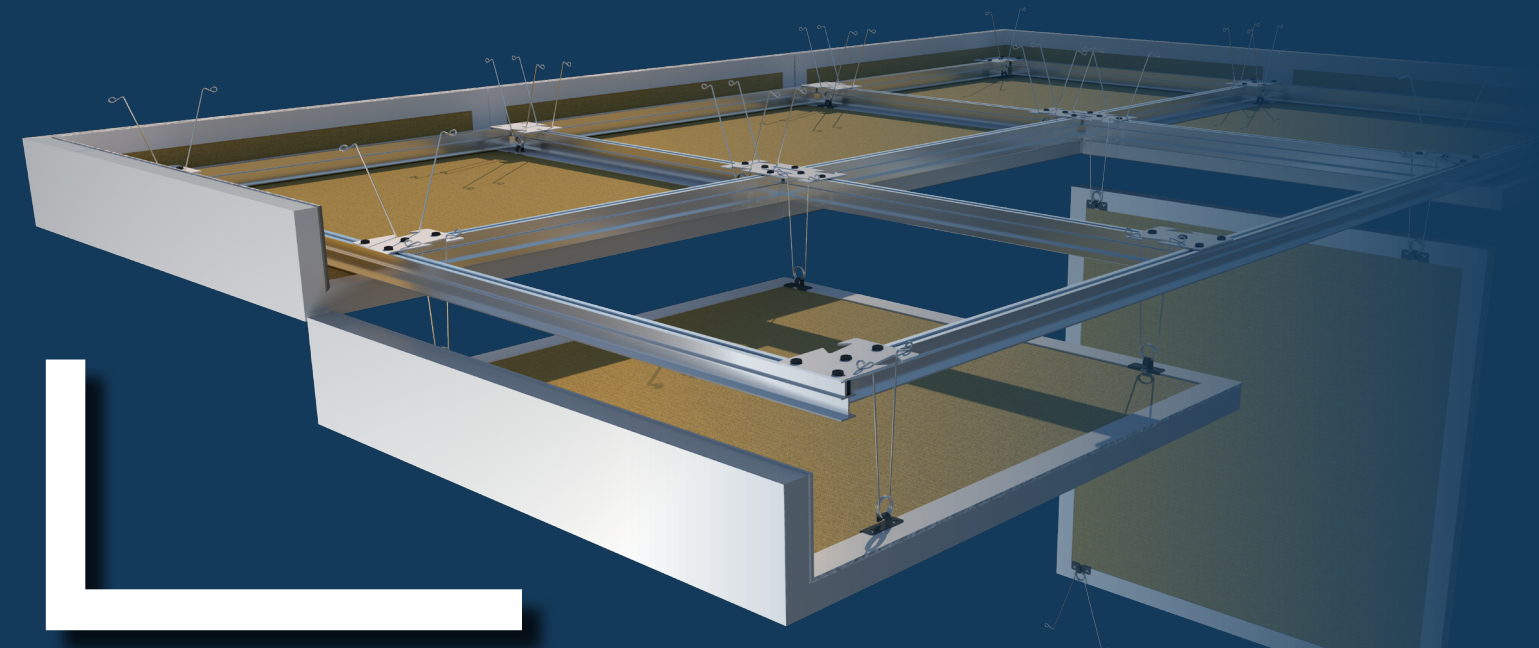



Project: Brooklyn Heights Library
Location: New York City, USA
Architect: Gensler
Finish: LEGNO- "Random match rift cut White Oak" (Micro perforated wood veneer)



LEGNO - The Beauty of wood, the sound of silence!



Project: Google Pier 57
Location: New York City, USA
Architect: Diller Scofidio + Renfro Architects
Finish: Fabric (Camira Blazer Felt)

GENERAL DATA

- Noise Reduction Coefficient (NRC) as tested to ASTM C423 in our 1" meets a 0.90 NRC
- Fire Performance as tested to ASTM E84 meets a Class "A" fire rating (Coated and LEGNO finish)
- Fire Performance as tested to CAN/ ULC S102.18 (Flame Spread Rating of 25) and (Smoke Development Classification of 40) (Coated Finish)
- Our Standard "AURA WHITE" in the coating system has been tested to ASTM E1477-9a and has a rating of 90% light Reflectance
- Ceiling Attenuation Class (CAC) Three options:
 - Standard = 32 CAC,
 - Medium=37 CAC(metalback)
 - High= 45+ with 2" Sky Acoustics High CAC system. As tested to ASTM E1414.



Camira Blazer Felt

DESIGN INSPIRATION

Sky Acoustics AURA panel system isn't just about aesthetics; it's a game-changer for sound control. The exceptional acoustic performance of AURA opens doors to diverse applications. From educational institutions seeking optimal speech intelligibility to concert halls aiming for pristine sound quality, AURA delivers.

The adaptability of AURA panels allows them to seamlessly integrate into any architectural design, ensuring that acoustic excellence is accessible across various industries. Moreover, the integration of AURA panels with the APTUS mounting system streamlines the installation process, making it a practical choice for projects of all scales.

With AURA, the possibilities for achieving high acoustic absorption, fully downward accessible and fitting into any design isn't just possible but will exceed your expectations.



LARGE FORMAT

Panels can be done in large format for grander spaces (sizes up to 5'x10')



THICKNESS

AURA panels are available in 1" and 2" thickness



MULTIPLE FINISHES

AURA comes in 5 unique finishes, from micro-perforated wood, perforated metal, Coated, Fabric, and Printed.



VAULTED

AURA panels can add depth and an exciting visual to any space.



DOMED

AURA panels create grand expressions while opening up the space.

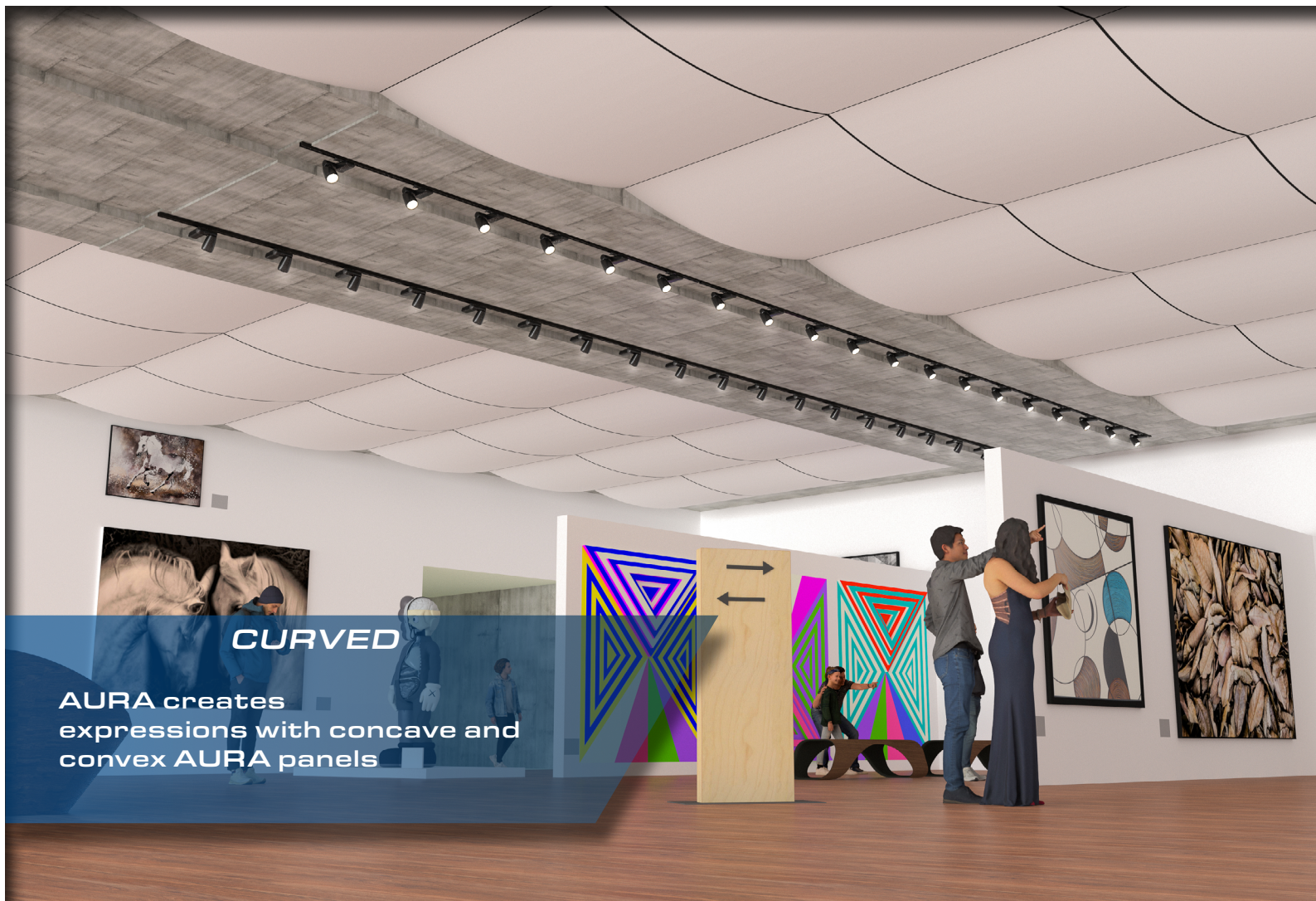

CURVED

AURA creates expressions with concave and convex AURA panels

AURA panels make a grand expression in any space!

AURA panels are custom-manufactured to cater to unique design needs, providing architects and designers with unparalleled design flexibility.

This adaptability unleashes a world of possibilities for creating acoustically optimized spaces that are not only functional but also visually striking.

Whether it's a modern office with sleek, curved acoustic panels or a dynamic auditorium with custom-designed AURA installations, the potential for stunning and acoustically superior spaces is limitless. AURA elevates the standard for acoustical ceiling and wall panels, enabling designers to turn their boldest ideas into reality.

AVAILABLE FINISHES



COATED

Smooth monolithic finish in our standard Aura White or any custom color!

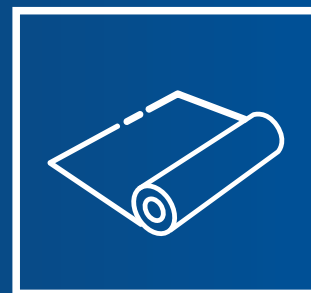

FABRIC

Many fabrics, vinyls and felts available from Guilford of maine, filzfelt, knoll, Design Tex, Maharam, Carnegie, Omnova and many more.

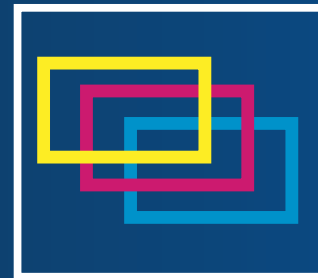

FINTO

Finto Finish
High resolution printed wood grain fabric available in 7 standard prints or can be customized.



LOHA

[Premium Finish]
Metal finishes available with custom perforations OR without perforation for maximum reflection.



LEGNO

[Premium Finish]
Real wood veneer microperforated at 0.55mm. 20+ standard veneers available.

AVAILABLE MOUNTING SYSTEMS



Aptus Torsion Spring Concealed Grid System

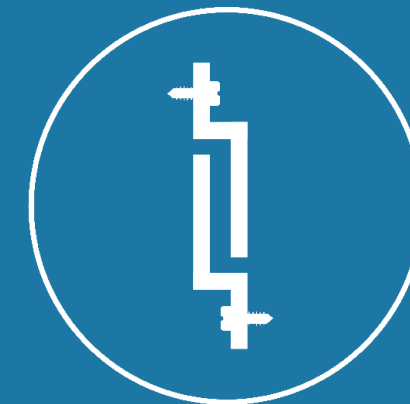

Direct Mount Wall Z-Clip & Track



Direct Mount Ceiling Z-Clip & Track

TECHNICAL DATA

FINISH	THICKNESS	FIRE RATING	NRC	CAC	CORE DENSITY	LEED	WARRANTY
COATED	1-1/16" (27 mm)	CLASS A	0.90 NRC	32 Standard, 37 Medium, 45+ High*	6-7 PCF	HPD's,EPD's,EDS, CDPH, Recycle content	2 YEARS
FABRIC	1-1/8" (28.6 mm)	CLASS A	0.90 NRC	32 Standard, 37 Medium, 45+ High*	6-7 PCF	HPD's,EPD's,EDS, CDPH, Recycle content	2 YEARS
LEGNO	1-1/8" (28.6 mm)	CLASS A	Perforation pattern depending	32 Standard, 37 Medium, 45+ High*	6-7 PCF	HPD's,EPD's,EDS, CDPH, Recycle content	1 YEAR
LOHA	Available in 2" or 52mm thickness	CLASS A	2-1/16" (52 mm) panels have a NRC of up to 1.05	*Different backers increase the CAC	N/A	HPD's,EPD's,EDS, CDPH, Recycle content	2 YEARS

LEED DATA

- **MR- Material and Resources**
1 Point - Building Product Disclosure and Optimization - EPD
- **1 Point - Building Product Disclosure and Optimization - HPD**
- **1 Point - Leadership Extraction Practice - Recycled Content**
- **IEQ-Indoor Environmental Quality(Prerequisite)**
- **1-2 Points - Interior Lighting/Surface Reflectivity (AURA WHITE FINISH) E1477- 9**
- **1-3 Points - Low Emitting Materials (CDPH)Must use our "G" Series Core**



VERSION 2.3



skyacoustics